

BATTERIES

Low Batteries & bad battery connections are the #1 cause of scale malfunction and inaccuracy! We test all of our scale returns from consumers and 60% of them are battery related problems. This sounds silly but it's true! A scale will perform poorly when it has low batteries. Use good quality batteries & replace them often (Remove the batteries if you plan to store the scale for longer then 14 days). We include good quality batteries with all of our scales but they can run low in storage. If your scale simply won't turn on while on battery power, it is often caused by loose battery connections.

Battery installation

- Press and lift open the battery cover located at the bottom of the unit.
- Insert the batteries and make sure the polarity is correct.
- Close the battery cover until it clicks shut.

Note : If the battery symbol appears in the display, it means low battery power. It is time to replace the batteries.

OPERATION INSTRUCTIONS

Weighing Procedures

- Press [**ON**] to turn on or off the scale.
- Press [**UNIT**] to select a weighing unit g, gn, lb:oz, 1/4oz, 1/8oz, ct, dwt.
- Start weighing

Tare

Tare can be used for eliminating the weight value of an empty container. Place an empty container on the scale and press [**TARE**]. After 3 seconds place the items to be weighed in the container. NOTE: When all weight is removed from the weighing tray, the tared value of a container will be displayed as a negative number. Press [**TARE**] again to return the scale to zero.

CALIBRATION

When to calibrate - calibration is recommended for best results.

Calibration may be required when the scale is first set up for use, or if the scale is moved to a different altitude or new location. This is necessary because the weight of a mass in one location is not necessarily the same in another location. Also, with time and use, mechanical deviations can occur.

To Calibrate the Triton® XL: you must have an accurate 100g, 500g & 1000g weight in order to calibrate.

1. Turn the scale off and place it on a flat, stable surface (be certain the scale is off).
2. Press and hold the **[UNIT]** key, then press and release **[Ⓢ]**, the display will show the a/d value .
3. Press the **[-0-]** key, the display will read "Zero" and then the correct calibration weight.
4. Gently place the 100g weight on the tray and wait for 3 seconds. The display will show the next calibration weight (500g).
5. Remove the 100g weight and place 500g weight on the platform wait for 3 seconds. The display will show the next calibration weight (1000g).
6. Remove the 500g weight and place 1000g weight on the platform wait for 3 seconds. The display will show "PASS".
7. Calibration is now complete. Remove the weight.

FEATURES

Power Up Segment Test

When first turning the unit on, the scale will run a quick diagnostic and it will display a countdown . This display will remain for a few seconds and then reset to zero.

Overload indicator

When the display shows "Err", this indicates an overload. Remove excessive load immediately. Remember: you can permanently damage the scale and void your warranty by overloading it!

Negative Value

Any tared value will be displayed as a negative number once all weight is removed, press **[-0-]** to re-zero the scale.

Auto off

An auto off feature is provided to conserve battery power. The unit will automatically turn off after 2 minutes of inactivity.

Expansion Tray/Cover

The protective cover of the Triton® XL™ is designed to also be used as a platform expansion tray. The cover can only be removed when the scale is fully open.

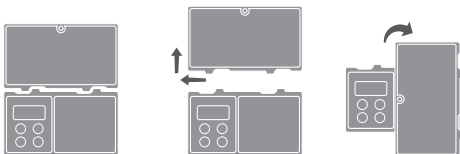

DISPLAY SYMBOLS

- **--0--** Scale at ZERO
- **↔** Scale is in TARE mode.
- **⊗** Batteries need replacing

SPECIFICATIONS

Capacity	1000g x 0.1g	Units	g, gn, lb:oz, 1/4oz, 1/8oz, ct, dwt
Auto-OFF	2 min.		
Scale dimension	187mm x 115mm x 20mm		
Tray dimension	117mm x 102mm		
Net/gross weight	320g		
Operating temperature	Optimum 10-30°C (50-86°F)		
Power Source	2 x AAA batteries		



COVER DOUBLES
AS TRAY



www.myweigh.com