



# JS-VG20

20g x 0.002g Capacity Gemological & Grain Scale



## USER MANUAL



# JS-VG20

20g x 0.002g Capacity Gemological & Grain Scale

---

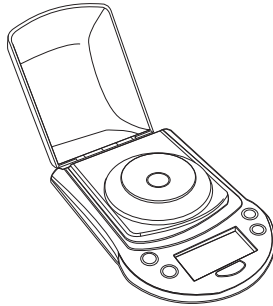

## USER MANUAL



Thank you for purchasing the J-SCALE® JS-VG20 digital scale. Please read all operating instructions carefully before use. This electronic scale is a precision instrument. With normal care and proper treatment, it will provide years of reliable service.

Never load the scale with more than the maximum capacity. Although the JS-VG20 is designed to be extremely durable with extra overload protection built into the case, overloading will permanently damage it! Avoid any exposure to extreme heat or cold, your scale works better when operated at normal room temperature. Keep your scale in a clean environment. Dust, dirt, moisture, vibration, air currents and/or a close proximity to other electronic equipment can all cause an adverse effect on the reliability and accuracy of your scale. Handle with care. Gently place all items to be weighed onto the platform. Avoid shaking, dropping or otherwise shocking the scale. Scales are delicate instruments and unlike cellular phones, scales have delicate sensors that determine how much an item weighs. If you drop or shock your scale, these sensors “feel” the shock and are sometimes destroyed. This happens with all digital scales. We design our scales to be as resistant to shock or drops as possible, however there is no way for us to protect 100% against load cell or sensor damage.

Failure to follow these instructions will void your warranty.

Always allow the scale to acclimate to normal room temperature for at least one hour before use. Give your scale sufficient warm up time. Usually 30-60 seconds before calibration to give the internal components a chance to stabilize.

## REMOVING THE WIND SHIELD

---

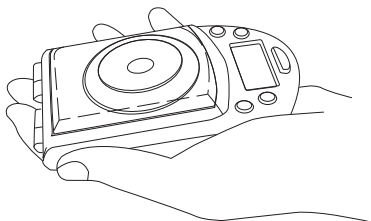

1

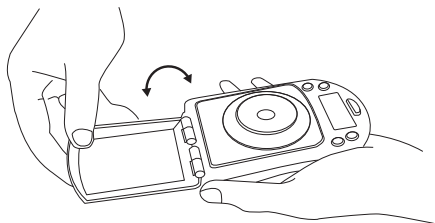

2

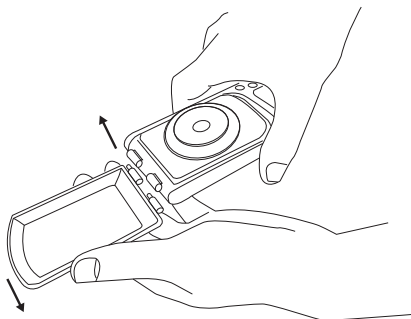

3

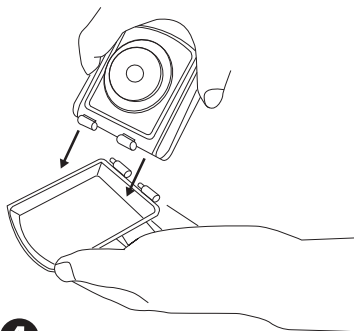

4

## OPERATION

1. Place the scale on a horizontal flat surface, press **[ON/OFF]** key to turn on the scale.
2. Wait until "0.00" is displayed.
3. Put the object(s) on the weighing platform.
4. Using the **[UNIT]** key, you can toggle the weighing units.

## TARE

1. Turn on scale as described above.
2. Place the "tare item" on the platform.
3. Press **[ZERO]** and wait until "0.0" is displayed.
4. Add the "net-weight-item".
5. Press **[ZERO]** again to return the scale to zero.

## PCS / COUNTING MODE

1. Press **[ON/OFF]** to turn on the scale. Wait for "0" to appear on the display.
2. Press **[UNIT]** several times until the scale is in PCS mode (the indicator should be on pcs).
3. Select the sample size by pressing **[PCS]**. Either 10, 20, 50 or 100.
4. Put the exact quantity of samples desired on the platform and press **[UNIT]**, the display will show "PASS".
5. Now you can place the items that you want counted onto the tray and the total number of items will show on the display.
6. Press the **[UNIT]** key to exit the counting function and return to normal weighing or you can press **[ON/OFF]** to turn the scale off.

## CALIBRATION

*You must have an accurate 20g weight in order to calibrate.*

1. Ensure the scale is off and place on a stable surface.
2. Press and hold **[UNIT]** button turn on the scale. Release **[UNIT]** when the display shows the AD value (a series of random numbers).
3. Press **[UNIT]** again, the LCD display will show "OSAVE" and then the required calibration weight.

4. Gently place the required weight on the scale and press **[UNIT]**.
5. The display will show "OSAVE" and return to the AD value.
6. Calibration is complete, remove the weight and turn the scale off.

## BACKLIGHT

Press the **[LIGHT]** key to turn on or off the backlight.

## WEIGHMETER™

On the side of the display you will notice a series of bars that increase as the load on the scale increases. This is our Weighmeter™ feature. It helps you know the remaining capacity on the scale and also will indicate an overload if one occurs. Please use the Weighmeter™ to monitor your weighing loads and please do not overload this scale.

## SPECIFICATIONS

<b>Tare Range</b>	Full capacity
<b>Op. Temp</b>	10 to 30 °C
<b>Power</b>	3 x AAA
<b>Scale Dim.</b>	125mm x 79mm x 25mm
<b>Tray</b>	Ø 40mm
<b>Capacity</b>	20g
<b>Readability</b>	0.002g
<b>Modes</b>	g, oz, dwt, ozt, ct, gn, mg, pcs
<b>Calibration</b>	20g

## DISPLAY ERROR MESSAGES

	Change the batteries
<b>[EEEE]</b>	Overload

