

Health o meter®

P r o f e s s i o n a l

This document hosted by
OldWillKnottScales
~ ~ CLICK HERE ~ ~
to visit us the next
time ya' need a scale!

**DIGITAL PHYSICIAN SCALE
MODEL 498KL**

**BALANCE ELECTRONIQUE
MODELE 498KL**

**BALANZA ELECTRONICA
MODELO 498KL**

**500 lb x 0.2 lb
220 kg x 0.1 kg**



MODEL 498KL

**OPERATION MANUAL
MODE D'EMPLOI
MANUAL DE OPERACION**

PLEASE REGISTER YOUR PRODUCT FOR WARRANTY AT WWW.HOMSCALES.COM

©Pelstar LLC 2009

Thank you for your purchase of this product. Please read this manual carefully and keep it handy for ready reference.
 Merci d'avoir acheté ce produit. Veuillez lire attentivement ce manuel et le garder a portée de main pour pouvoir le consulter a tout moment.
 Gracias por la adquisicion d'este producto. Léa por favor este manual cuidadosamente y manténgalo a su alcance para una referencia.

English.....3
 Francais.....7
 Espanol.....13

TABLE OF CONTENTS

CAUTION AND WARNING3
 SCALE SPECIFICATIONS3
 STORAGE SPECIFICATIONS3
 SETUP.....4
 OPERATION INSTRUCTIONS4-5
 MAINTENANCE AND CLEANING.....5
 TROUBLESHOOTING.....5
 CALIBRATION6
 WARRANTY.....6

CAUTION AND WARNING





To prevent injury and damage to your scale, please follow these instructions very carefully

- Do not transport the scale while platform is loaded.
- For accurate weighing the scale must be placed on a flat, stable surface.
- For accurate weighing, verify proper operation according to the procedure described in this manual before each use,
- Do not use in the presence of flammable materials.
- Operating at other voltages and frequencies than specified could damage the equipment.
- If the "LOW BAT" indicator activates, for accurate weighing replace the batteries or connect the scale to an AC power source as soon as possible.
- Only manufacturer's qualified personnel shall service the scale.

The equipment generates, uses and may radiate radio frequency energy and, if not installed and used in accordance with these instructions, may cause harmful interference to other devices in the vicinity. However, there is no guarantee that interference will not occur in a particular installation. If this equipment does cause harmful interference with other devices, which can be determined by turning the equipment off and on, the user is encouraged to try to eliminate the interference by one or more of the following measures:

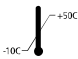
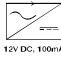
- Reorient or relocate the receiving device.
- Increase the separation between the equipment.
- Connect the equipment into an outlet on a circuit different from that to which the other device(s) is connected.
- Consult the manufacturer or field service technician for help.

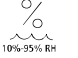
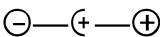
DEFINITION OF SYMBOLS

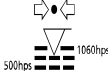
	Attention, Consult Accompanying Documents		Temperature range		AC to DC power supply
	Type BF Applied Parts		Humidity range		DC Connector Polarity
	AC to DC power supply		Atmospheric pressure range		

SCALE SPECIFICATIONS

Capacity and Resolution	500lb x 0.2lb / 220kg x 0.1kg
Power Requirements	Adapter model ADPT31* (IEC) 120 VAC-9V DC 60Hz (NOT INCLUDED) OR 6-AA cell 1.5V batteries (INCLUDED) Adapter model ADPT30* (USA-CSA only) 120-240 VAC-9VDC 50-60Hz (NOT INCLUDED)
Environmental	Operating temperatures: 50°F to 104°F / 10°C to 50°C Atmospheric Pressure: 500hPa – 1060hPa Humidity: 10% - 95% RH
Platform Dimensions:	17 3/4" x 14" x 2 1/4" / 43cm x 35.6 cm x 5.8 cm
Display Dimensions:	8" x 4 1/2" x 2" / 20.4cm x 11.7cm x 4.9cm

STORAGE SPECIFICATIONS

Storage Temperatures:	32°F to 122°F / 0°C to 50°C
Humidity:	10% - 95% RH
Atmospheric Pressure:	500hPa – 1060hPa

***WARNING:** For use with AC Adapter Model CSD 1200100U-31/ADPT31 (IEC only)
 For use with AC Adapter Model UE 1200100U-31/ ADPT30 (USA-CSA)
 Complies with C22.2 No. 601.1-M90 and UL Std No. 60601-1. Type BF applied parts.
 Internally powered. Equipment is not suitable for use in the presence of a flammable anesthetic mixture with air or with oxygen or nitrous oxide.



INSTALLING BATTERIES

1. Locate the battery compartment on the bottom of the remote display head.
2. With a Phillips screwdriver remove the screw from the battery compartment cover and remove cover.
3. Place 6 new AA batteries into battery compartment. Make sure the '+' and '-' are positioned correctly, as shown on the bottom of the battery compartment. Replace the batteries when the display reads 'LobAt' (Use only AA alkaline batteries).
4. Replace the battery compartment cover.

NOTE: Dispose used batteries in accordance to your country's national requirements.

AC OPERATION

Plug the adapter (NOT INCLUDED) into the base of the scale and into power source.

PREPARING THE SCALE FOR USE

1. Plug the coiled "phone" cord into the base of the scale.
2. Remove the protective plastic film from the display.
3. Turn the scale on by pressing the ON/OFF button. The display will show "Start" and then "0.0".

NOTE: If set up instructions failed, refer to the troubleshooting instructions. If the problem is not corrected, refer to Health o Meter® Professional technical support at 1-800-638-3722.

REMOTE HEAD MOUNTING

The remote head can be mounted to a wall up to 6 feet from the base or it can be mounted on the display bracket (included) for placement on a table up to 6 feet from the base.

To Mount on Wall

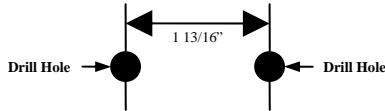

1. Use the above diagram to locate the position of the screws at the desired height.
2. Drill two holes 1 13/16" apart.
3. Screw the two screws into the wall, let the screw heads protrude 1/8" from the wall. Extending the screw heads further could damage the scale.
4. Align the holes on the back of the remote display with the screws. The remote head should slide onto the screw heads firmly and securely.

To Mount on Display Bracket

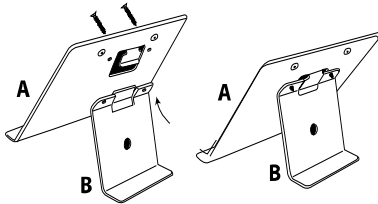

1. While holding Part A (Stand) as illustrated in the figure to the left, slide the center tab of Part B (Support) up and under the tab on the back of the Stand.
2. Align the Stand and the Support so the tab on the rear of the Support can slide beneath the tab on the rear of the Stand. The holes on the Stand and Support should line up.
3. Insert the two small screws (included) into the two holes in the front of the Stand and through the holes in the Support.
4. Using a Phillips screwdriver, tighten the screws to secure the Stand to the Support.
5. Slide the two protruding knobs on the bracket into the two holes in the back of the remote display. The display bracket is now ready for use.

OPERATING INSTRUCTIONS

QUICK START INSTRUCTIONS

1. Press the ON/OFF button to turn the scale on. "START" will appear on the display for 4-5 seconds, then "0.0" will be displayed.
2. Have the patient to step on the scale. After the weight has stabilized, the stable weight icon and the patient's weight will be displayed.
3. The stable weight will continue to be displayed until the patient steps off the scale. The display will again show "0.0".

DESCRIPTION	FUNCTION
ON/OFF	Turns the scale ON and OFF.
HOLD/RELEASE	Holds the value of the weighed object on the display until the button is pressed again.
ZERO	Zeros the display prior to weighing; enables the cancellation of weight if some object was placed on the scale.
LB/KG	Toggles between pounds and kilograms.
CLEAR	Clears the incorrect height input when in BMI mode.
BMI	Prompts entry of data to calculate the patients Body Mass Index (BMI)
ENTER	Used to accept height in BMI mode.
UP	Increases height input (0.5 in / 0.5 cm increments)
DOWN	Decreases height input (0.5 in / 0.5cm increments)



BMI CALCULATION

1. Complete steps 1 and 2 of the Quick Start Instructions.
2. While the patient is standing on the scale, press the BMI button. A number representing a default height will appear on the display.
3. Select the correct or closest height measurement by pressing the UP or DOWN buttons.
4. Confirm the height input by pressing the ENTER button and the BMI will be displayed.
5. Press the CLEAR button to return display to normal weighing operation.

HOLD FUNCTION

1. Complete steps 1 and 2 of the Quick Start Instructions.
2. While the patient is standing on the scale, press the HOLD/RELEASE button to activate the hold function. The stable weight will continue to be display until the hold function is cancelled.
3. To cancel hold function, press the HOLD/RELEASE button again. The scale will return to normal weighing operation.

AUTO OFF FUNCTION

As an energy saving feature, the scale will automatically turn off after 2 minutes of inactivity.

De-activating auto-off

1. While the scale is turned off, press and hold the "HOLD/RELEASE" button.
2. While holding the "HOLD/RELEASE" button, press the "ON/OFF" button to turn the scale on.
3. "START" will briefly appear on the display followed by "AOF=0".
4. Auto off is now disabled and the scale will remain on until the scale is manually turned off.

Activating auto-off

1. While the scale is turned off, press and hold the "HOLD/RELEASE" button.
2. While holding the "HOLD/RELEASE" button, press the "ON/OFF" button to turn the scale on.
3. "START" will briefly appear on the display followed by "AOF=1".
4. Auto off is now enabled.

KG & LB LOCK OUT

The default weighing mode for this scale can be changed from LB/KG to KG only or LB only.

To change weighing mode:

1. Press the ON/OFF button to turn the scale on.
2. Wait for "0.0" to appear on the display.
3. Press and hold the LB/KG button until the unit of measure begins to flash.
4. Release the LB/KG button and the scale will operate in the selected mode.
5. Repeat steps 3-4 to change the weighing mode to a different unit of measure.

MAINTENANCE AND CLEANING

Before first use and after periods of non-use, check the scale for proper operation. Disconnect the scale from the AC power source.

1. To clean the scale, wipe the outside of the scale with a soft cloth and mild detergent. Do not use abrasive cleaners. Never place the scale in the water or spray with liquid.
2. This scale contains electronic parts. Use it carefully. Do not drop, kick or jump on it.
3. Do not store near chemicals, heaters or radiators.
4. Do not store scale on its side.
5. This scale is an extremely sensitive weighing device. Items such as clothing or towels placed or dropped on the scale may cause it to activate. In order to prevent run down of the battery, do not place anything on the scale.

TROUBLESHOOTING

Refer to the following instructions to check and correct any failure before contacting service personnel.

SYMPTOM	POSSIBLE CAUSE	CORRECTIVE ACTION
Scale does not turn on	<ol style="list-style-type: none"> 1. Battery 2. Bad Power Supply 3. Faulty electrical outlet 	<ol style="list-style-type: none"> 1. Replace the batteries 2. Replace Power Supply 3. Use a different outlet
Questionable weight or the scale does not zero	<ol style="list-style-type: none"> 1. External object interfering with the scale 2. The display did not show "0.0" before weighing 3. Scale is not placed on a level surface 4. Scale is out of calibration 	<ol style="list-style-type: none"> 1. Remove interfering object from the scale 2. Ask the patient to step off the scale. Zero the scale and begin weighing process again. 3. Place scale on level surface 4. Check weight with know weight value
The display shows "OVER"	The load on the scale exceeds capacity (500 lbs)	Remove weight, turn scale off, turn scale on again and try again
The display shows "UNDER"	Load on the scale is below initial zero point	Clear scale of any weight and re-zero scale by pressing ZERO button
The display shows "LobAt"	The batteries are low	Replace batteries according to instructions

1. Press and hold the LB/KG and ZERO buttons at the same time, then press the ON/OFF button to turn on the scale. "CAL" will appear on the display followed by a number.
2. Press the ZERO button. "C-100" will flash on the display and then the display will return to "0".
3. Place 100 lbs on the scale and when calibration number stabilizes, press the ZERO button. "C-200" will appear on the display and then the display will return to "0".
4. Place 200 lbs on the scale and when calibration number stabilizes, press the ZERO button. "C-300" will appear on the display and then the display will return to "0".
5. Place 300 lbs on the scale and when calibration number stabilizes, press the ZERO button. "C-500" will appear on the display and then the display will return to "0".
6. Place 500lbs on the scale and when calibration number stabilizes, press the ZERO button. "End" will appear on the display and then the scale will automatically turn off.

LIMITED WARRANTY

What does the Warranty Cover?

Pelstar LLC scales are warranted from date of purchase against defect of materials or in workmanship for a period of one (1) year. If product fails to function properly, return the product, freight prepaid and properly packed to Pelstar. See "To Get Warranty Service" below for instructions. If manufacturer determines that a defect of material or workmanship exists, customers' sole remedy will be repair or replacement of scale at no charge. Replacement will be made with a new or remanufactured product or component. If the product is no longer available, replacement may be made with a similar product of equal or greater value. All parts including repaired and replaced parts are covered only for the original warranty period.

Who is covered?

The original purchaser of the product must have proof of purchase to receive warranty service. Pelstar dealers or retail stores selling Pelstar products do not have the right to alter, or modify or any way change the terms and conditions of this warranty.

What is excluded?

Your warranty does not cover normal wear of parts or damage resulting from any of the following: negligent use or misuse of the product, use on improper voltage or current, use contrary to the operating instruction, abuse including tampering, damage in transit, or unauthorized repair or alterations. Further, the warranty does not cover Acts of God, such as fire, flood, hurricanes and tornadoes. This warranty gives you specific legal rights, and you may also have other rights that vary from country to country, state to state, providence to providence or jurisdiction to jurisdiction.

To get Warranty Service make sure you keep your sales receipt or document showing proof of purchase.

Call 1 (800) 638-3722 or 1 (708) 377-0600 to receive a return authorization number. Attach proof of purchase to your defective product along with your name, address, daytime number and description of the problem. Carefully package the product and send with shipping and insurance prepaid to:

Pelstar LLC
Attention R/A# _____
Repair Department
11800 South Austin Avenue Unit B
Alsip, IL 60803, U.S.A.

If your scale is not covered by warranty, or has been damaged, an estimate of repair costs or replacement costs will be provided to you for approval prior to servicing or replacing.

Pelstar LLC
11800 South Austin Avenue Unit B Alsip, IL, 60803, U.S.A.
1 (800) 638-3722 or 1 (708) 377-0600
www.homscales.com

Health o meter Professional products are manufactured, designed and owned by Pelstar LLC.
Health o meter® is a registered trademark of Sunbeam Products Inc., Boca Rotan, FL 334331.
©Pelstar LLC 2009

Not Legal for Trade